



# Pad site

39,204 SF Available





2785 Highway 46, Wasco, CA 98503

 **JLL** SEE A BRIGHTER WAY

# Property Highlights

- Highly visible 39,204 SF (0.90 AC) pad on hard corner of Highway 46 and Central Ave.
- Across the street from market's only Walmart Supercenter.
- Excellent frontage on Wasco's primary thoroughfare.

# Demographics

	1 mile ▼	3 miles ▼	5 miles ▼
	<b>9,390</b> Total Population	<b>23,322</b> Total Population	<b>27,895</b> Total Population
	<b>3.6</b> Avg. Household Size	<b>3.6</b> Avg. Household Size	<b>3.7</b> Avg. Household Size
	<b>\$73,687</b> Avg. HH Income	<b>\$67,302</b> Avg. HH Income	<b>\$67,650</b> Avg. HH Income
	<b>\$252,424</b> Median Home Value	<b>\$243,045</b> Median Home Value	<b>\$243,469</b> Median Home Value

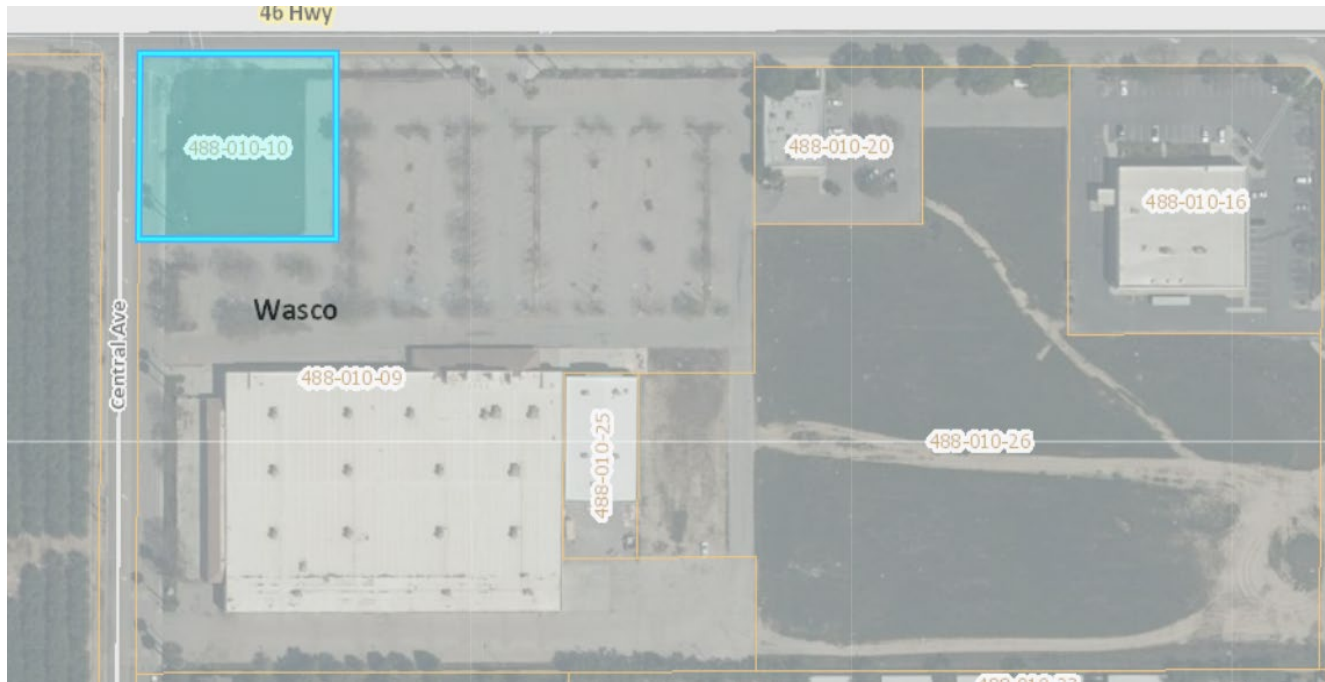



# Amenity map





# Site plan



## JLL

### **Shauna Mattis**

*Managing Director*

+1 310 749 4790

shauna.mattis@jll.com

### **Francesca Howard**

*VP, Retail Broker*

+1 310 536 6334

francesca.howard@jll.com

### **Liam Bredberg**

*Associate*

+1 424 294 3450

liam.bredberg@jll.com

### **Ian Jost**

*Associate*

+1 424 294 3443

ian.jost@jll.com

#### **About JLL**

For over 200 years, JLL (NYSE: JLL), a leading global commercial real estate and investment management company, has helped clients buy, build, occupy, manage and invest in a variety of commercial, industrial, hotel, residential and retail properties. A Fortune 500 company with annual revenue of \$20.9 billion and operations in over 80 countries around the world, our more than 103,000 employees bring the power of a global platform combined with local expertise. Driven by our purpose to shape the future of real estate for a better world, we help our clients, people and communities SEE A BRIGHTER WAY<sup>SM</sup>. JLL is the brand name, and a registered trademark, of Jones Lang LaSalle Incorporated. For further information, visit [jll.com](http://jll.com).