

Former Kmart

87,543 SF Available

320 S. 25th Street
Easton, PA 18042



Surrounding
Retailers Include:



Property Information

- + Extraordinary road infrastructure, visibility, and access at the Route 22 interchange
- + Situated in the highly desirable & growing Lehigh Valley region
- + Excellent location for grocery, last mile, discount retail & medical

Contact Us

Jeffrey Cohen
Executive Vice President
484 567 2368
jeffrey.cohen@cbre.com
Licensed: DE, PA
Licensed Salesperson: NJ

Nelson Wax
Senior Associate
484 567 3347
nelson.wax@cbre.com
Licensed: DE, PA
Licensed Salesperson: NJ

CBRE, Inc.
T 610 834 8000
F 610 834 1793
Licensed Real Estate Broker
www.cbre.us/PhiladelphiaRetail

87,543 SF Available

320 S. 25th Street | Easton, PA 18042

For Lease

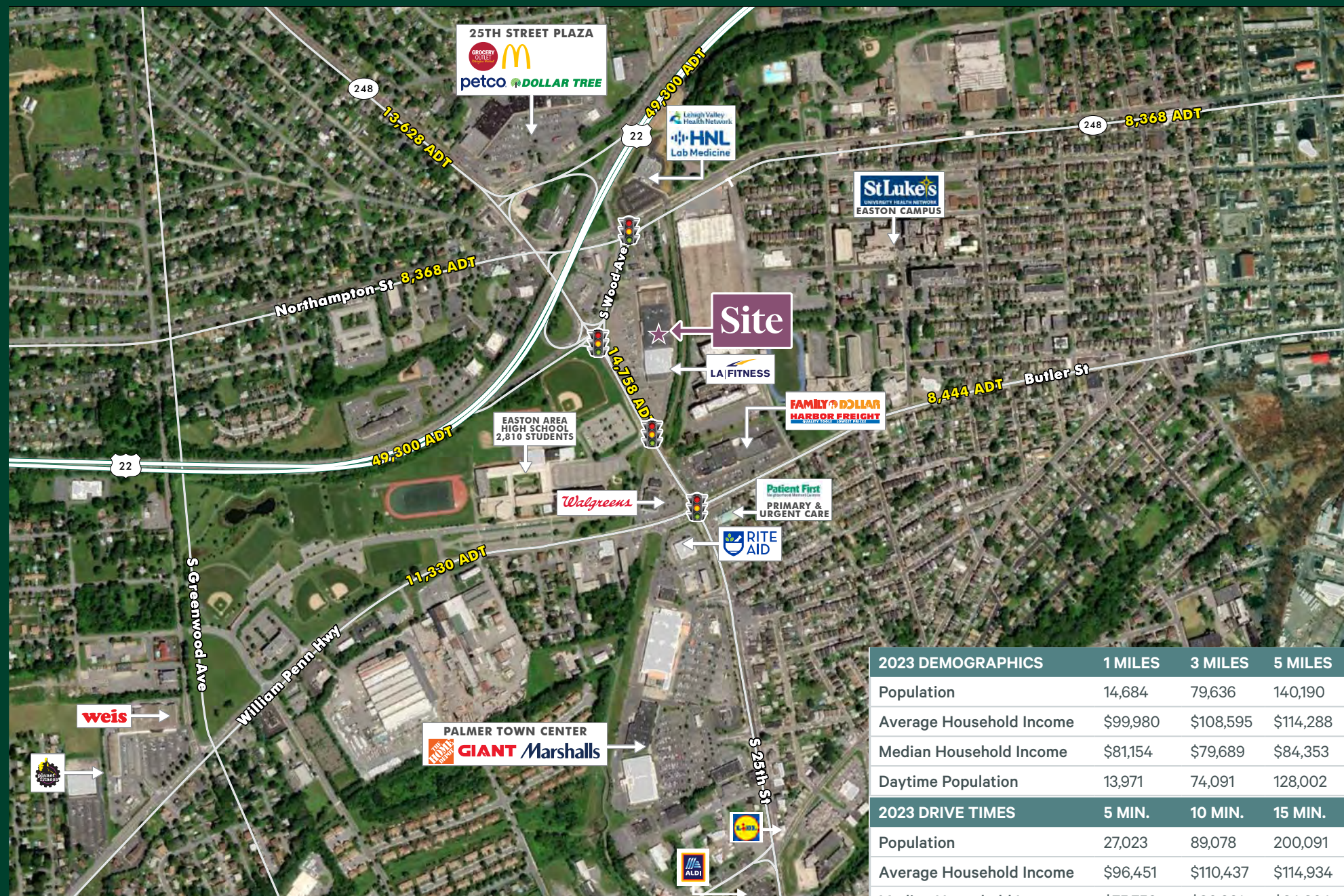

2023 DEMOGRAPHICS	1 MILES	3 MILES	5 MILES
Population	14,684	79,636	140,190
Average Household Income	\$99,980	\$108,595	\$114,288
Median Household Income	\$81,154	\$79,689	\$84,353
Daytime Population	13,971	74,091	128,002
2023 DRIVE TIMES	5 MIN.	10 MIN.	15 MIN.
Population	27,023	89,078	200,091
Average Household Income	\$96,451	\$110,437	\$114,934
Median Household Income	\$75,758	\$80,661	\$84,804
Daytime Population	23,659	85,386	190,183

320 S. 25th Street | Easton, PA 18042

Space Plan

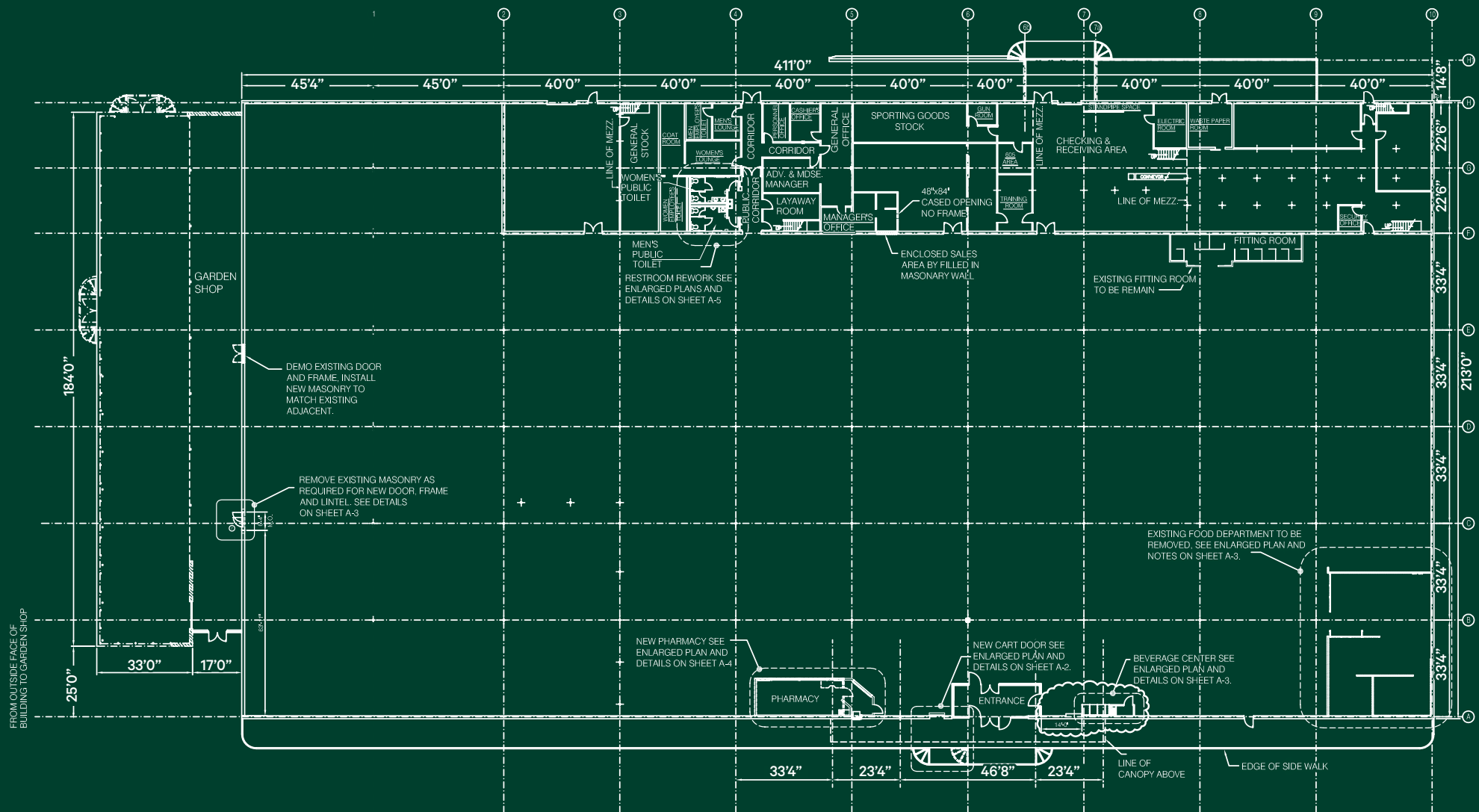
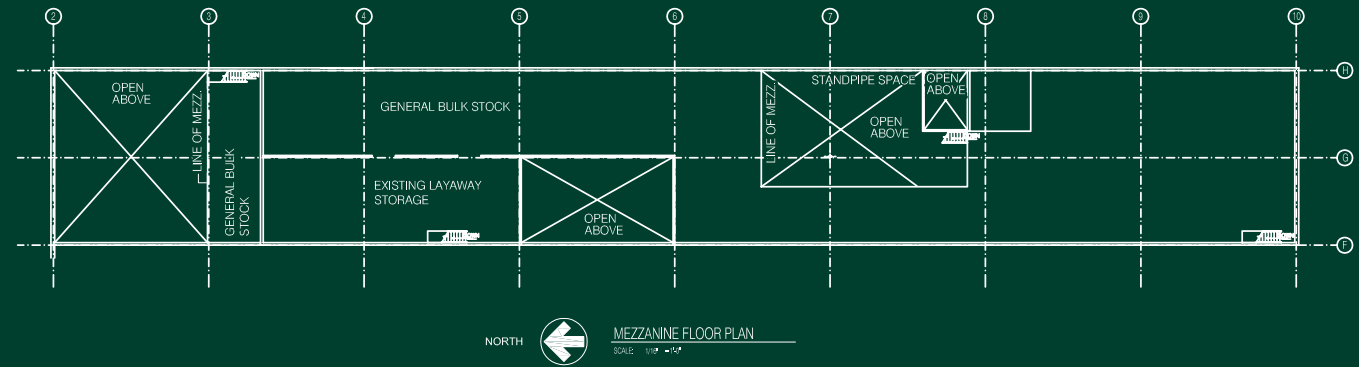

87,543 SF Available

320 S. 25th Street | Easton, PA 18042

For Lease



© 2023 CBRE, Inc. All rights reserved. This information has been obtained from sources believed reliable, but has not been verified for accuracy or completeness. You should conduct a careful, independent investigation of the property and verify all information. Any reliance on this information is solely at your own risk. CBRE and the CBRE logo are service marks of CBRE, Inc. All other marks displayed on this document are the property of their respective owners, and the use of such logos does not imply any affiliation with or endorsement of CBRE. Photos herein are the property of their respective owners. Use of these images without the express written consent of the owner is prohibited.

www.cbre.us/retail

CBRE