

50

# MALL DRIVE

Newport Centre

JERSEY CITY, NJ





**Auto Center**

**Sears**

**Sears**  
ROYAL LEPAGE REALTY

**Sears**  
ROYAL LEPAGE REALTY

**ENTER**

**National Express Delivery Service**

NO PARKING  
ANY TIME  
ON THIS STREET



## SITE PLAN

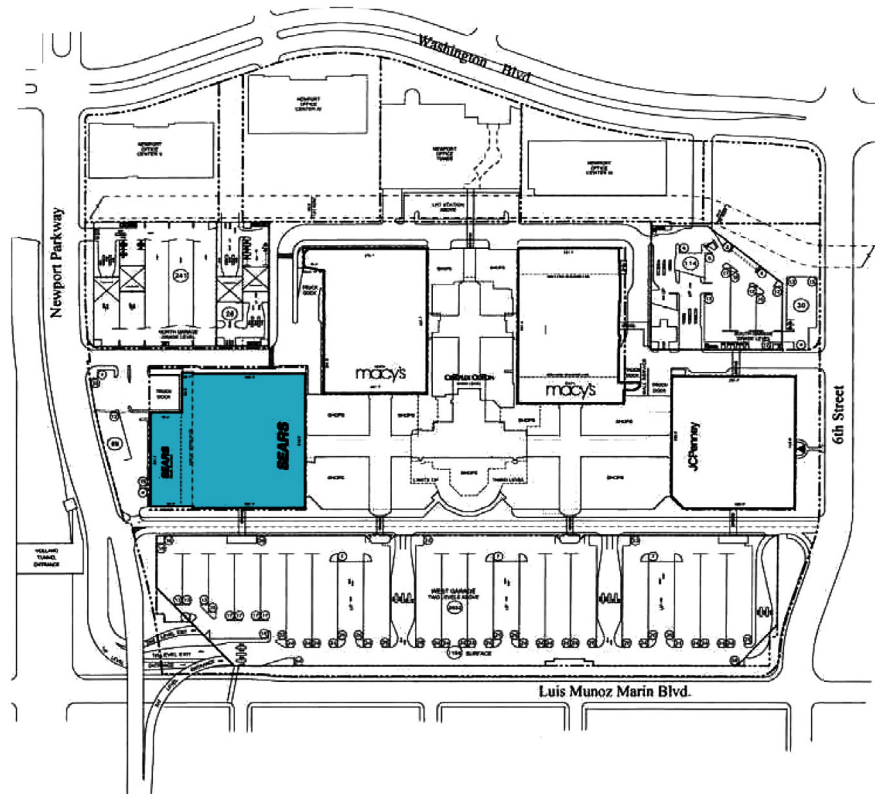

## GROUND FLOOR

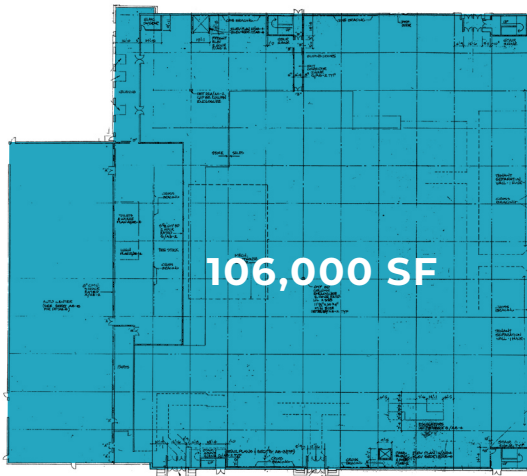

## SECOND FLOOR

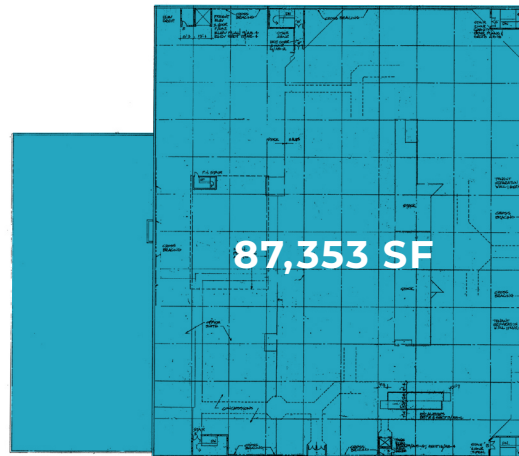

# Space Details

## Space

Ground Floor  
106,000 SF

Second Floor  
87,353 SF

Total  
193,353 SF

## Site Status

Currently Sears

## Frontage

315 FT on Newport Parkway

361 FT on Mall Drive West

286 SF on Mall Drive East

## Comments

Prime location with parking and convenient loading

# Demising Floor Plans

## GROUND FLOOR

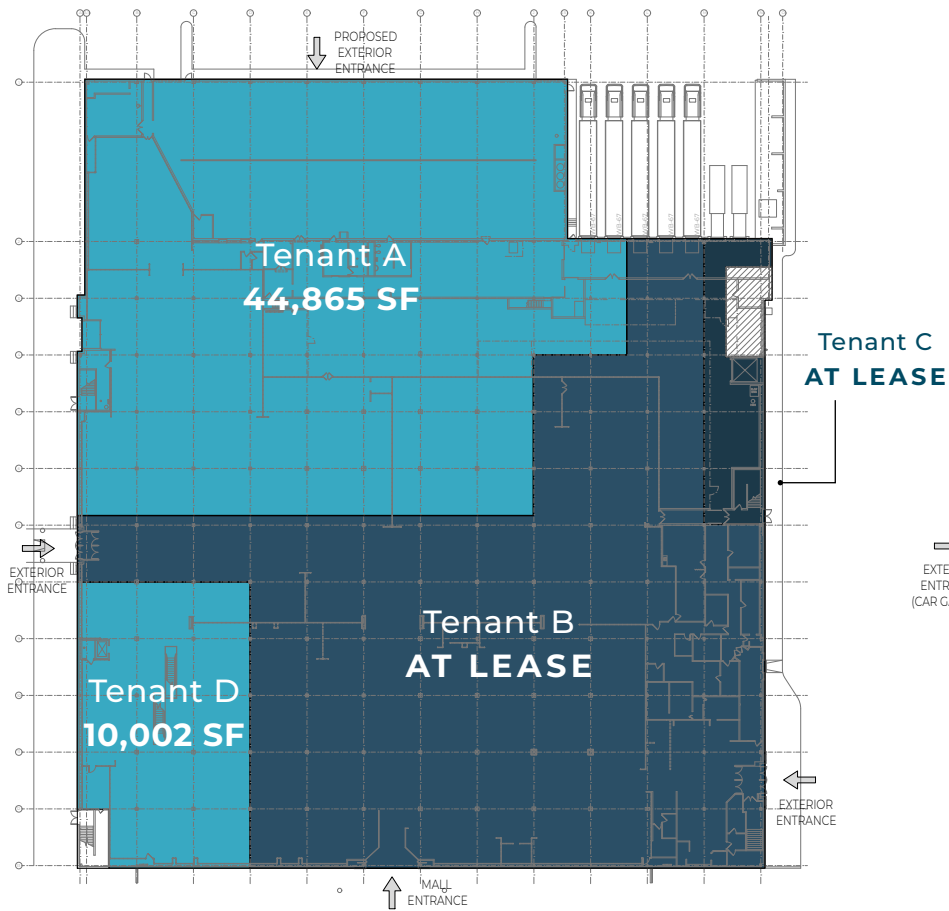

## SECOND FLOOR

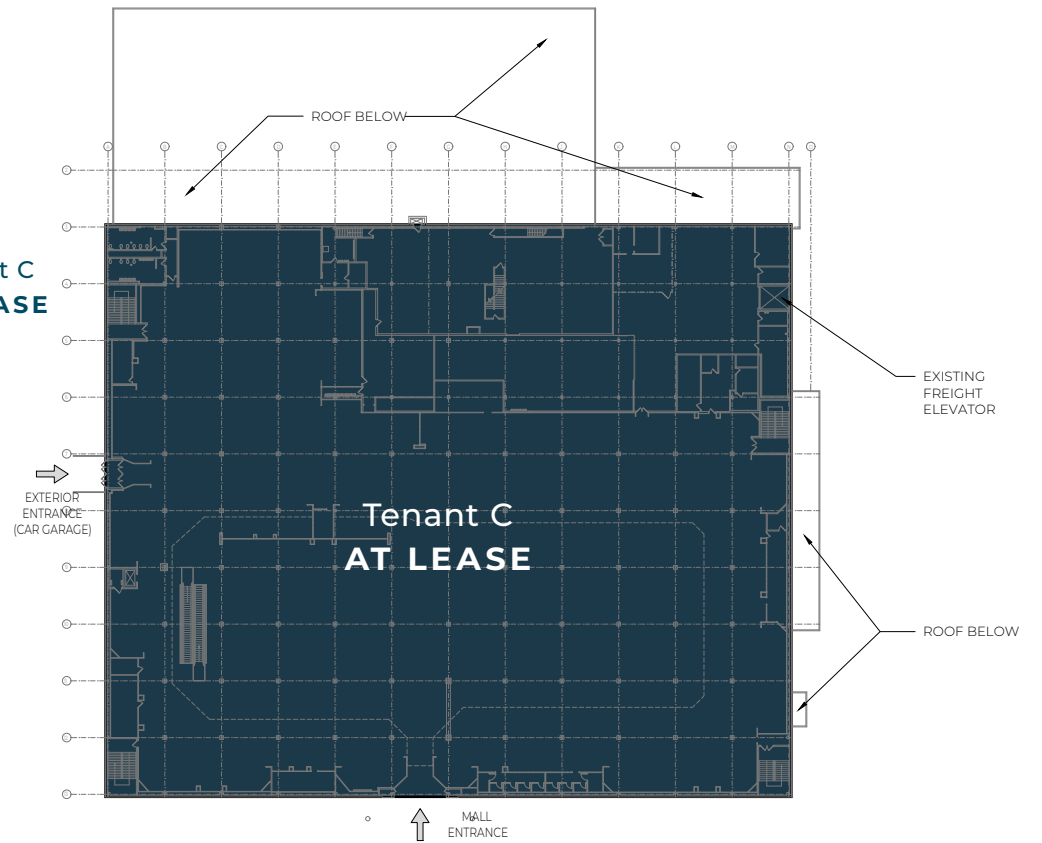



# Join The Sixth Borough

## 11K

Apartment units have been constructed in downtown Jersey City since 2010

## 3.4K

Multifamily residential units are currently under construction in downtown Jersey City

## 3.8K

Permits to construct new residential units were issued in Jersey City over the past 18 months, more than any other NJ municipality

## 10.3K

Additional units are in the planning stages for downtown Jersey City

**NEWPORT** is a city unto itself with over 6,000,000 SF of office, over 1,500,000 SF of retail and over 6,500 residential units. The Newport PATH Station has more than 5,500,000 annual passengers.

**THE NEWPORT CENTRE** in Jersey City is home to national retailers such as Kohls, Macy's, AMC Theatre, Zara, H&M, Chic Fil A, Adidas, Zin Burger, and more. With over 190,000 SF of retail available, join the action in Newport!

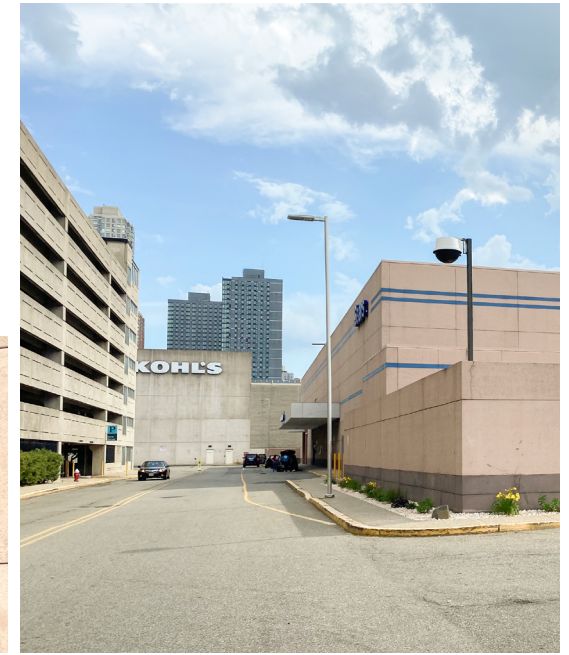



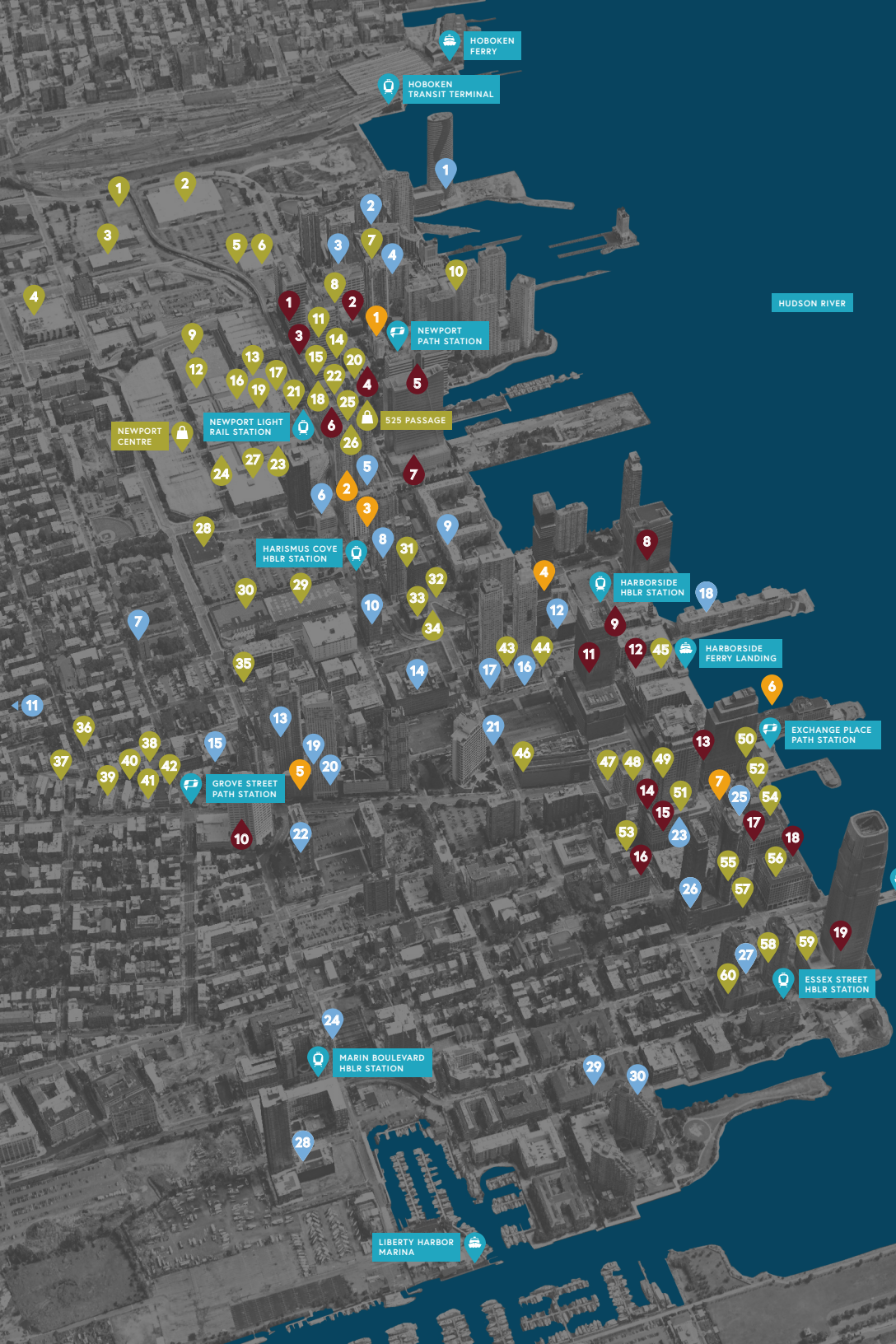

## RETAIL

- |  |  |   |   |
|--|--|---|---|
| <ul style="list-style-type: none"> <li>🏠 Newport Centre</li> <li>📍 525 Passage</li> <li>01 ACME Markets</li> <li>02 Target</li> <li>03 Best Buy</li> <li>04 Home Depot</li> <li>05 Modell's</li> <li>06 Staples</li> <li>07 Merton Williams</li> <li>08 Menya Sandaime</li> <li>09 Sears</li> <li>10 Duane Reade</li> <li>11 Dorrian's Red Hand</li> <li>12 H&amp;M</li> <li>13 Kohl's</li> <li>14 Cosi</li> </ul> | <ul style="list-style-type: none"> <li>15 Just Salad</li> <li>16 Zara</li> <li>17 Zinburger</li> <li>18 Chiptole</li> <li>19 AMC Theaters</li> <li>20 B.GOOD</li> <li>21 The Cheesecake Factory</li> <li>22 Gregorys Coffee</li> <li>23 Macy's</li> <li>24 Forever 21</li> <li>25 Los Cuernos</li> <li>26 Ruth's Chris Steak House</li> <li>27 JCPenney</li> <li>28 Bed Bath &amp; Beyond</li> <li>29 BJ's Wholesale</li> <li>30 ShopRite</li> </ul> | <ul style="list-style-type: none"> <li>31 Chili's</li> <li>32 Massage Envy</li> <li>33 V's Barbershop</li> <li>34 European Wax Center</li> <li>35 Hudson Hall</li> <li>36 Talde</li> <li>37 Barcade</li> <li>38 Pasta E Vino</li> <li>39 The Ashford</li> <li>40 Porta</li> <li>41 Two Boots Pizza</li> <li>42 Roman Nose</li> <li>43 CycleBar</li> <li>44 CVS</li> <li>45 Piggyback Bar</li> <li>46 Five Guys</li> </ul> | <ul style="list-style-type: none"> <li>47 CAVA</li> <li>48 B.Good</li> <li>49 Adventures in Learning</li> <li>50 Gregorys Coffee</li> <li>51 Au Bon Pain</li> <li>52 Starbucks</li> <li>53 Iron Monkey</li> <li>54 Potbelly Sandwich Shop</li> <li>55 Hudson Greene Market</li> <li>56 CVS</li> <li>57 Caffe Bene</li> <li>58 Krispy Pizza</li> <li>59 Yaso Tangbao</li> <li>60 Learning Ladders</li> </ul> |
|--|--|---|---|

## HOTELS

- |  |  |  |   |
|--|--|--|---|
| <ul style="list-style-type: none"> <li>01 Courtyard by Marriott</li> <li>02 The Westin</li> <li>03 DoubleTree by Hilton</li> <li>04 Candlewood Suites</li> </ul> | <ul style="list-style-type: none"> <li>178 units</li> <li>425 units</li> <li>198 units</li> <li>214 units</li> </ul> | <ul style="list-style-type: none"> <li>05 Residence Inn by Marriott</li> <li>06 Hyatt Regency</li> <li>07 Hyatt House</li> </ul> | <ul style="list-style-type: none"> <li>152 units</li> <li>351 units</li> <li>258 units</li> </ul> |
|--|--|--|---|

## RESIDENTIAL

- |   |  |   |  |  |   |
|---|--|---|--|--|---|
| <ul style="list-style-type: none"> <li>01 The Ellipse Apartments</li> <li>02 123 River Drive</li> <li>03 Newport Apartments</li> <li>04 Shore Club Condominiums</li> <li>05 Monaco</li> <li>06 VV Metro Plaza</li> <li>07 Villa Borinquen</li> <li>08 Marbella</li> <li>09 Avalon Cove</li> <li>10 The One</li> <li>11 Dixon Mills</li> <li>12 Jersey City Urby</li> <li>13 The Morgan at Provost Square</li> <li>14 Modera Lofts</li> <li>15 Grove Pointe</li> </ul> | <ul style="list-style-type: none"> <li>Existing</li> <li>Existing</li> <li>Existing</li> <li>Existing</li> <li>Existing</li> <li>Existing</li> <li>Existing</li> <li>Existing</li> <li>Existing</li> <li>Existing</li> <li>Existing</li> <li>Existing</li> <li>Existing</li> <li>Existing</li> </ul> | <ul style="list-style-type: none"> <li>381 units</li> <li>850 units</li> <li>4,250 units</li> <li>428 units</li> <li>523 units</li> <li>421 units</li> <li>425 units</li> <li>380 units</li> <li>504 units</li> <li>452 units</li> <li>433 units</li> <li>762 units</li> <li>417 units</li> <li>366 units</li> <li>458 units</li> </ul> | <ul style="list-style-type: none"> <li>16 Trump Bay Street</li> <li>17 Trump Plaza Residences</li> <li>18 The Pier</li> <li>19 90 Columbus</li> <li>20 70 Columbus</li> <li>21 50 Columbus</li> <li>22 Metropolis Towers</li> <li>23 99 Hudson</li> <li>24 18 Park</li> <li>25 77 Hudson</li> <li>26 70 Greene Apartments</li> <li>27 Liberty Towers</li> <li>28 Vantage</li> <li>29 100 Dudley</li> <li>30 Portside Towers</li> </ul> | <ul style="list-style-type: none"> <li>Existing</li> <li>Existing</li> <li>Under Construction</li> <li>Existing</li> <li>Existing</li> <li>Under Construction</li> <li>Existing</li> <li>Existing</li> <li>Existing</li> <li>Existing</li> <li>Existing</li> <li>Existing</li> <li>Existing</li> <li>Existing</li> <li>Existing</li> </ul> | <ul style="list-style-type: none"> <li>447 units</li> <li>431 units</li> <li>422 units</li> <li>539 units</li> <li>545 units</li> <li>400 units</li> <li>800 units</li> <li>781 units</li> <li>422 units</li> <li>481 units</li> <li>480 units</li> <li>649 units</li> <li>448 units</li> <li>527 units</li> <li>527 units</li> </ul> |
|---|--|---|--|--|---|

## OFFICES

- |  |   |   |  |
|--|---|---|--|
| <ul style="list-style-type: none"> <li>01 Newport Office Center 5</li> <li>02 Newport Office Center 6</li> <li>03 Newport Office Center IV</li> <li>04 Newport Office Tower</li> <li>05 Newport Office Center 1</li> </ul> | <ul style="list-style-type: none"> <li>06 Newport Office Center 3</li> <li>07 Newport Office Center 7</li> <li>08 Harborside Plaza 10</li> <li>09 Harborside Plaza 3</li> <li>10 95 Columbus Drive</li> </ul> | <ul style="list-style-type: none"> <li>11 Harborside Plaza 5</li> <li>12 Harborside Plaza 2</li> <li>13 10 Exchange Place</li> <li>14 Harborside Plaza 1</li> <li>15 101 Hudson Street</li> </ul> | <ul style="list-style-type: none"> <li>16 95 Greene Street</li> <li>17 90 Hudson Street</li> <li>18 70 Hudson Street</li> <li>19 30 Hudson Street</li> </ul> |
|--|---|---|--|

## TRANSIT

- 🚶 Path
- 🚌 New Jersey Transit (Bus)
- 🚇 Hudson-Bergen Light Rail
- 🚢 NY Waterway Ferry





# Contact Exclusive Agents

# NEWMARK

**JASON PRUGER**  
 212.372.2092  
[jason.pruger@nmrk.com](mailto:jason.pruger@nmrk.com)

**DEAN TSELEPIS**  
 201.460.5156  
[dean.tselepis@nmrk.com](mailto:dean.tselepis@nmrk.com)

© 2022 NEWMARK. The information contained herein has been obtained from sources deemed reliable but has not been verified and no guarantee, warranty or representation, either express or implied, is made with respect to such information. Terms of sale or lease and availability are subject to change or withdrawal without notice. All renderings are conceptual.