

# Former Sears Flagship Woodfield Mall - Schaumburg, IL



Woodfield Mall

JCPenney PRIMARK ENTERRIUM  
 MICHAEL KORS GAP VS CHAMPS  
 SEPHORA VICTORIA'S SECRET MORPHE  
 GameStop Bath & Body Works  
 Z GALLERY ANTHROPOLOGIE  
 Apple H&M SUPERDRY 冒险魂

## GENERATIONAL OPPORTUNITY

- 31 Acres
- 307,000 SF Former Department Store
- 31,000 SF Former Automotive Building

Crate&Barrel  
 ← WHOLE FOODS MARKET

JARED

NORDSTROM

macys

5.11  
 DXL

ASHLEY

DSW  
 DECOR'S BICE WAREHOUSE

290

136,300 VPD

McConnor Pkwy

Perimeter Dr

9,650 VPD

For more information, please contact:

**Brendan Reedy**

630.954.7390  
 BReedy@midamericagr.com

**Jimmy Danaher**

630.954.7238  
 JDanaher@midamericagr.com



TRANSFORMCO

# Site details

## TRAFFIC

- #1 Shopping Destination in Illinois
- 17 Million Annual Visits
- 2 Million Square Feet

## AFFLUENT DEMOGRAPHICS

- 1.4 Million Trade Area Population
- \$110,000 Average HH Income
- Nearly 1 million Employees

## TOP SUBURBAN LOCATIONS-HOME TO

- 30 + hotels
- 30 Million SF of office, Industrial and retail space
- 200+ Restaurants
- \$2.9 Billion annual retail sales

## EASY ACCESS

- Just off I-90, I-290 & IL-53
- 5+ traffic light entrances

## RETAIL CO-TENANCY

- 280+ Brands
- Trend Ahead Brands
- Best In Class Brands
- Nordstrom, Apple, Sephora, Morphe, Michael Kors, Coach, Superdry



# Proposed Outlet Configuration



# Site plan

## Level 1 Conceptual Demising Plan

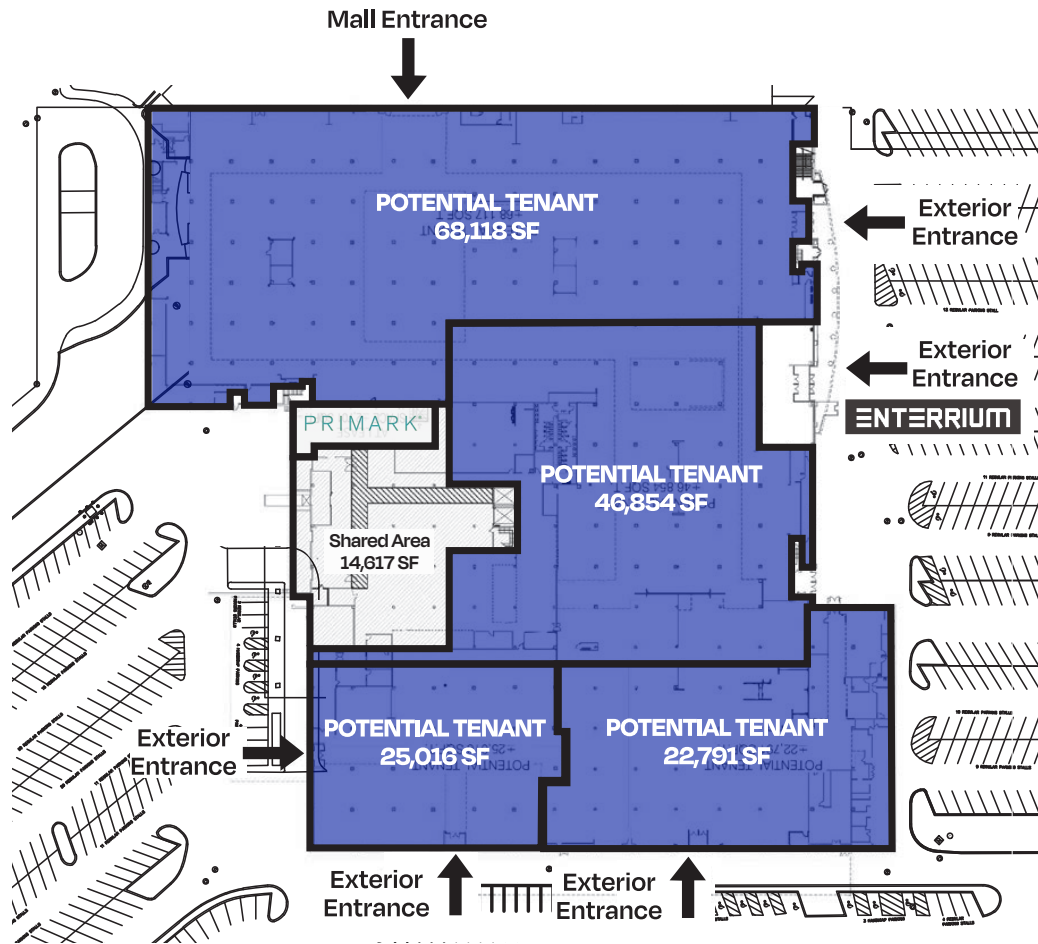

## Level 2 Floor Plan

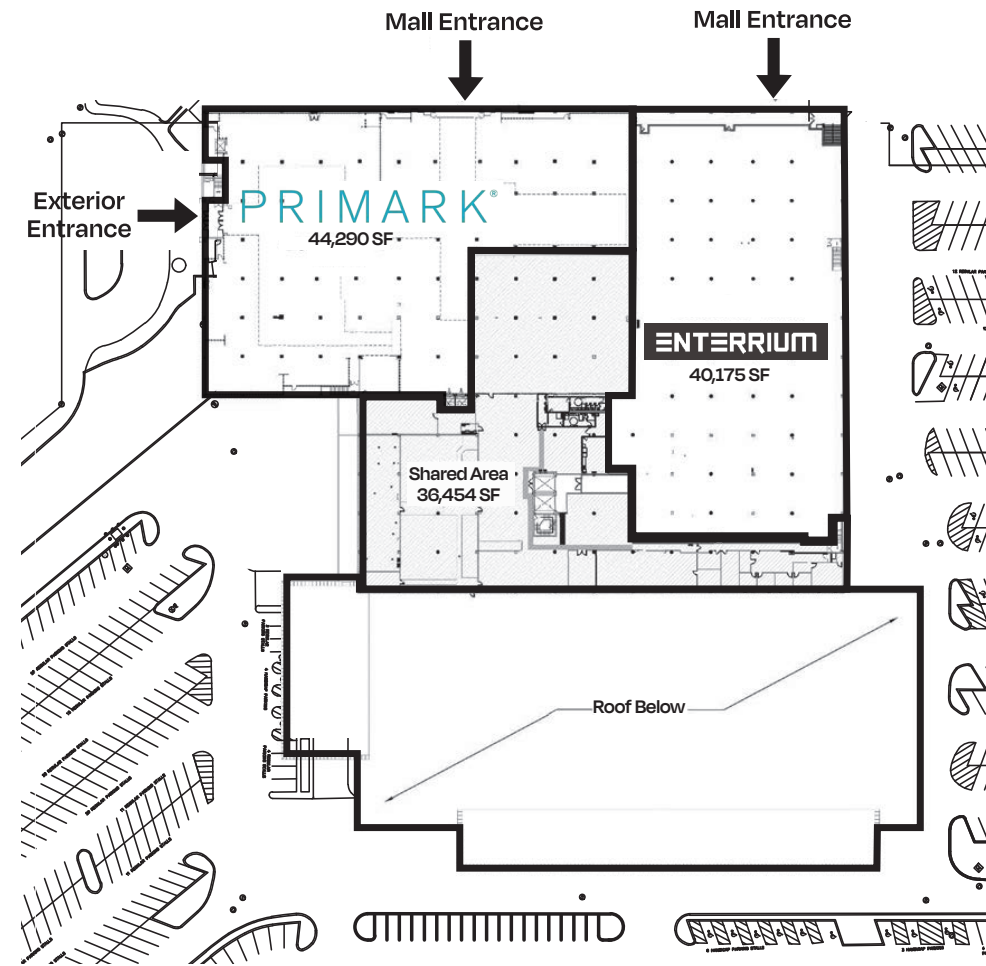

# location overview

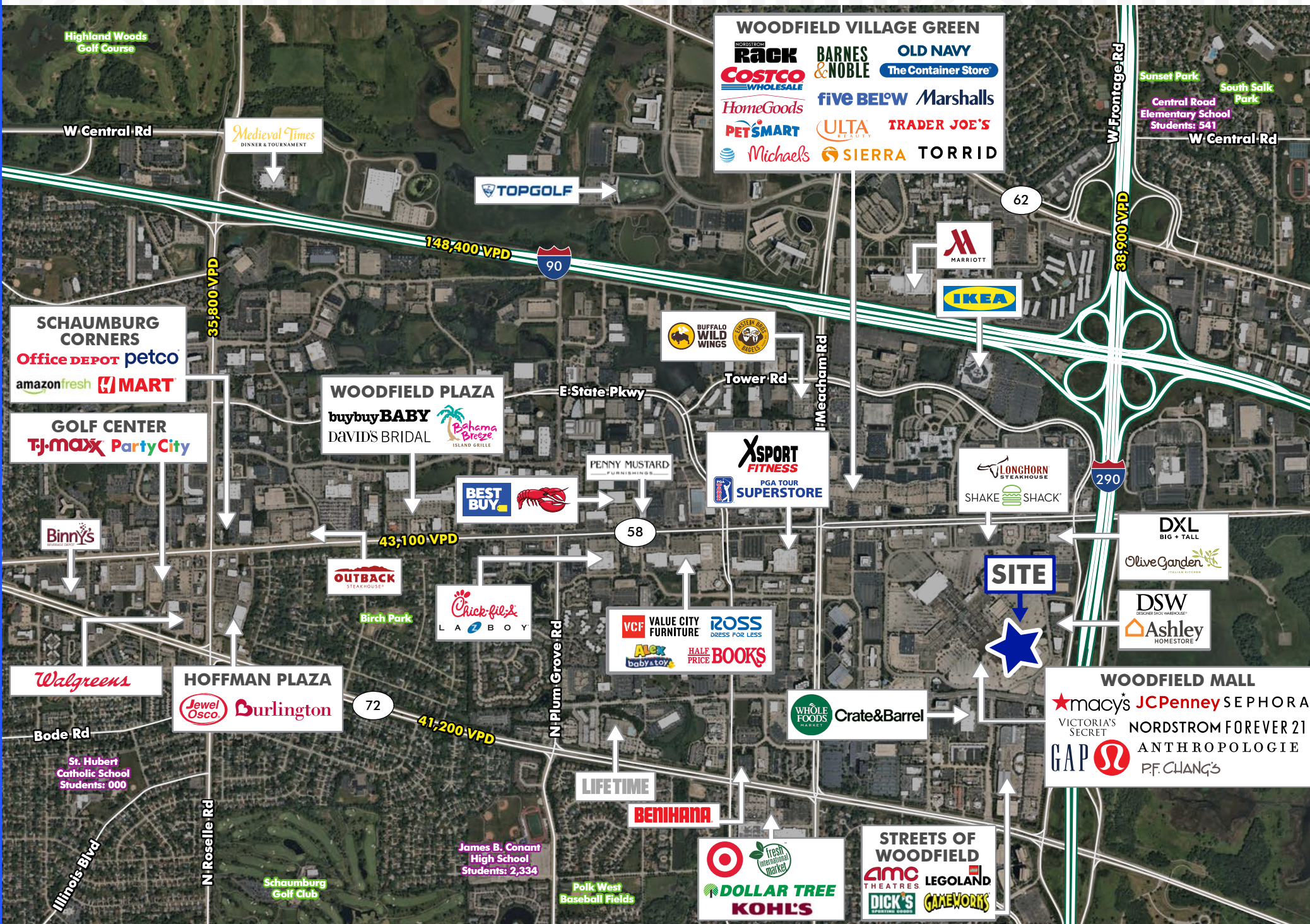



## area demographics



Total  
Population

81,609

3 MILE



Daytime  
Population

131,816

3 MILE



Avg Household  
Income

\$127,327

3 MILE



Consumer  
Expenditure

\$170.8M

DINING - 3 MILE

\$96.1M

APPAREL - 3 MILE

# Former Sears Flagship Woodfield Mall - Schaumburg, IL



For more information, please contact:

**Brendan Reedy**  
 630.954.7390  
 BReedy@midamericagr.com

**Jimmy Danaher**  
 630.954.7238  
 JDanaher@midamericagr.com

