

Available

Property Highlights

- Opportunity to acquire space attached to a highly trafficked, superregional mall that welcomed 3.6 million visits and 934,000 unique customers over the last 12 months
- Excellent roadway access and visibility (+73,700 VPD)
- Excellent demographics, transportation infrastructure and proximity to Center City Philadelphia underlines strength of Moorestown submarket

Property Description

Under 12 miles from Center City Philadelphia, the Moorestown Mall is centrally located in a dynamic regional market, bifurcated by NJ Rte 38, Rte 73 and I-295. The phased East Gate Square developments that flank the mall and grocery anchor (ShopRite) and other major big box retailers (Home Depot, Dick's Sporting Goods, Best Buy, Ulta) have solidified the Moorestown Mall as a center of gravity retail destination in the affluent Cherry Hill / Moorestown submarket within the Philadelphia MSA. The available space is attached to the superregional Moorestown Mall, which welcomed 3.6 million visitors over the last 12 months, and offers excellent roadway access to the highly trafficked Rte 38 (+44,900 VPD) and Rte 73 (+73,700 VPD).

Rt 38 And Lenola Rd

Rt 38 and Lenola Rd
Moorestown, NJ 08057

Colin Behr
Jones Lang LaSalle
215.399.1819
colin.behr@am.jll.com

Dan Zelsen
Charter Realty & Development
203.227.2922
dan@chartweb.com



us.jll.com/retail



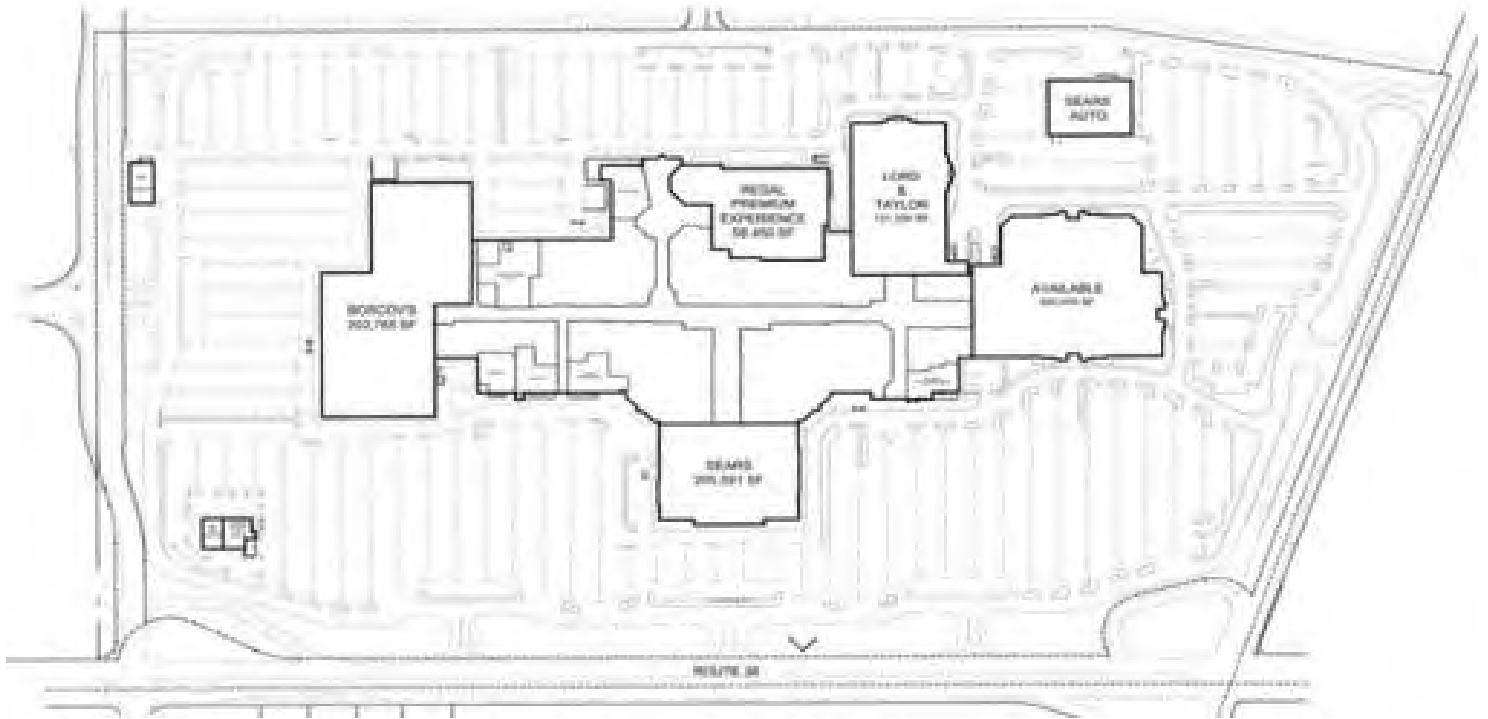

Property Data

Property Name	Sears - Moorestown Mall
Available Space	204,477 GLA on three levels
Lot Size	13.0 Acres
Zoning	Specially Restricted Commercial Area (SRC)

Demographics

	1 Mile	3 Mile	5 Mile	10 Mile
Total Population	344	77,678	204,448	1,161,301
Total # Households	1,599	31,515	78,836	431,679
Average Household Income	\$105,716	\$118,644	\$129,056	\$88,626

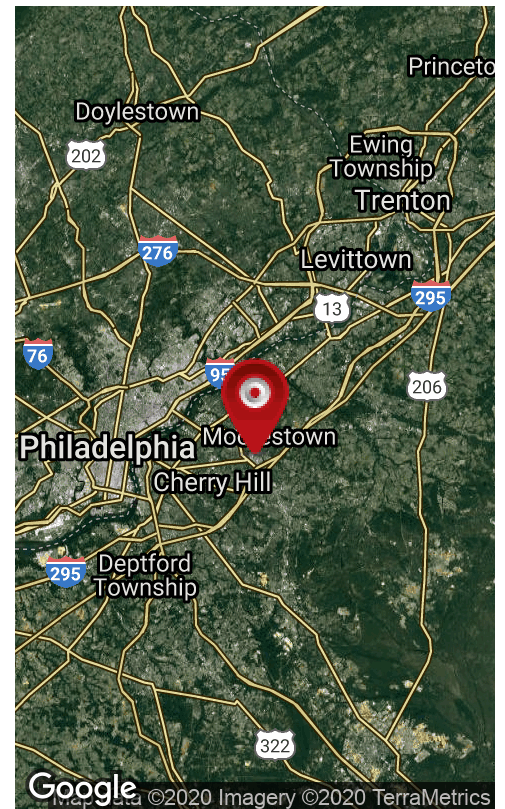

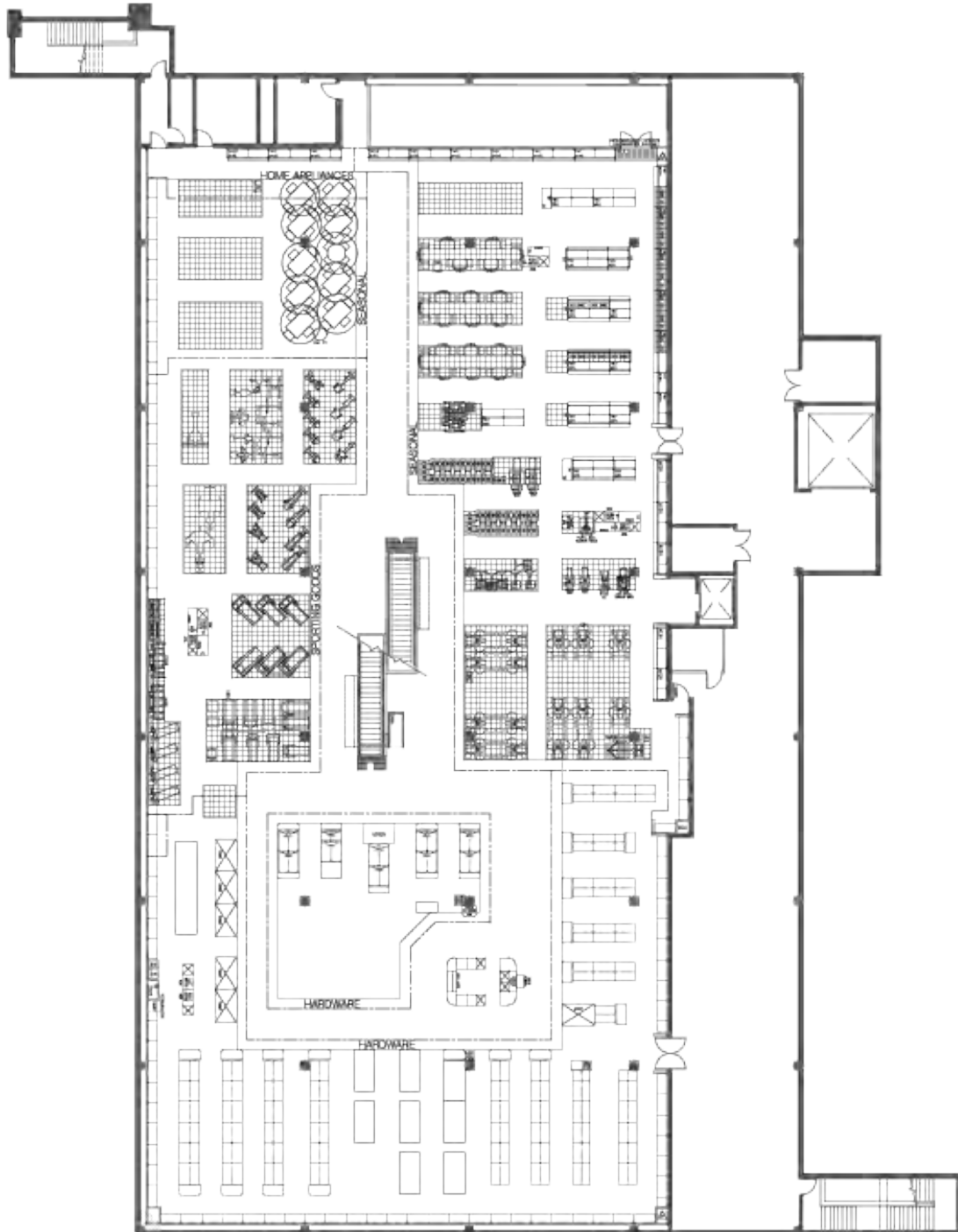

Floor 1

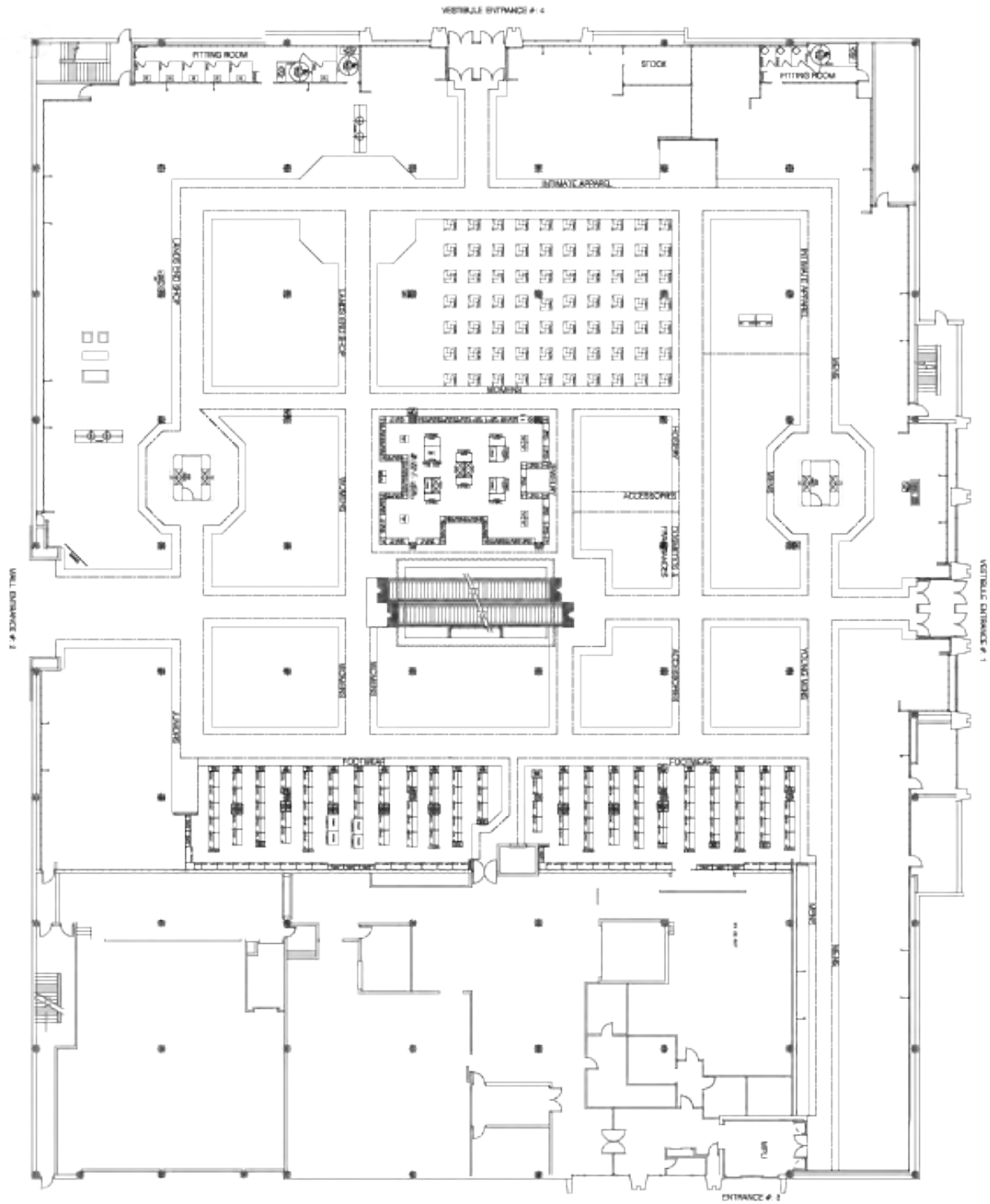

Floor 2

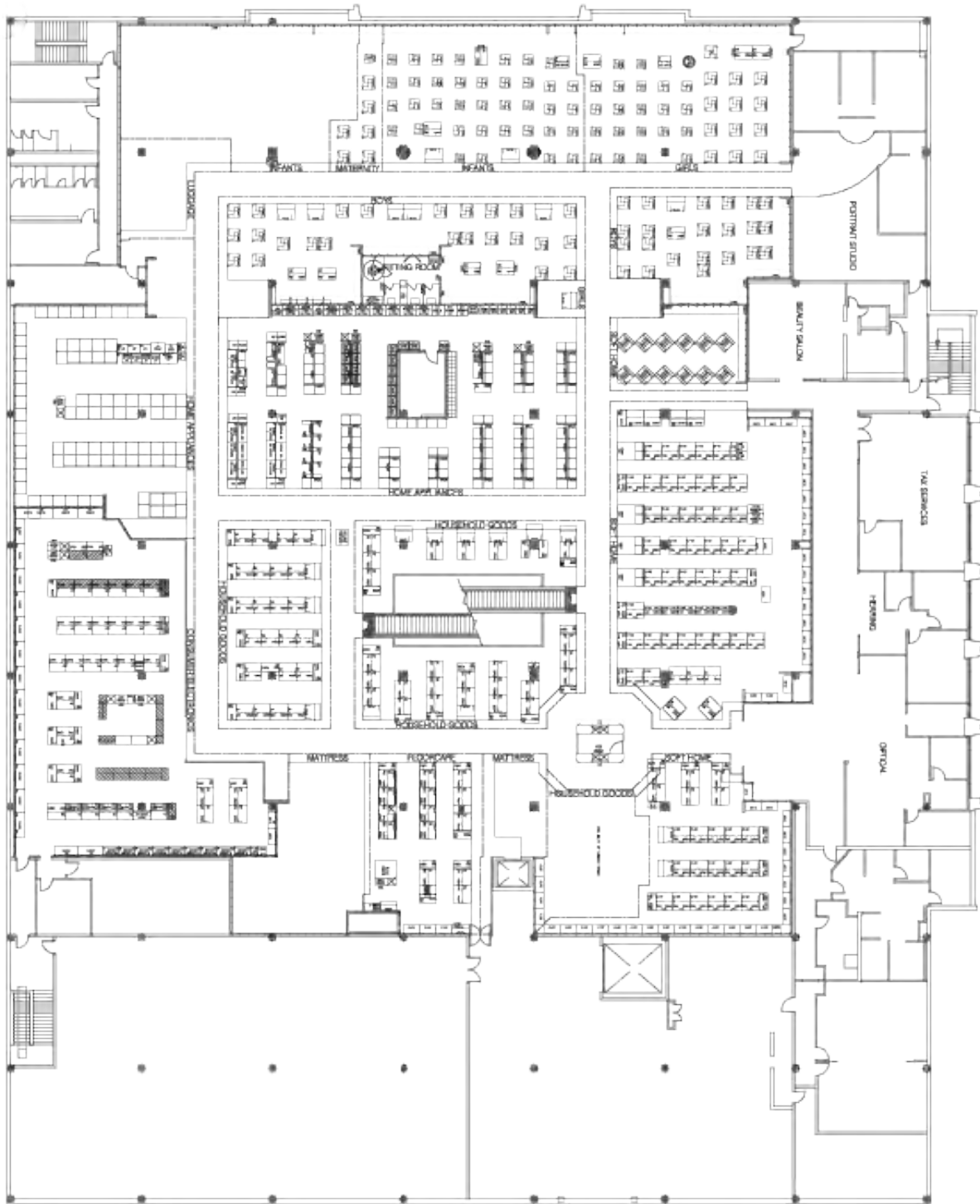

Floor 3

